

# Merced 2020

California Partnership for the San Joaquin Valley  
March 16, 2018

Richard Cummings  
University of California, Merced  
[rcummings2@ucmerced.edu](mailto:rcummings2@ucmerced.edu)

UNIVERSITY OF CALIFORNIA  
**MERCED**



## The University of California, Merced is the newest campus in the University of California system



University of California, Berkeley  
First Graduating Class, 1873



University of California, Merced  
First Graduating Class, 2009

Berkeley UNIVERSITY OF CALIFORNIA	UCSF	UCLA	UCSB	UC DAVIS UNIVERSITY OF CALIFORNIA	UC RIVERSIDE	UC San Diego	UC IRVINE	SANTA CRUZ UNIVERSITY OF CALIFORNIA	UC MERCED
1869	1873	1919	1944	1959	1959	1964	1965	1965	2005



## UC has a legacy of meeting California's needs

UC Irvine, 1965



UC San Diego, 1964

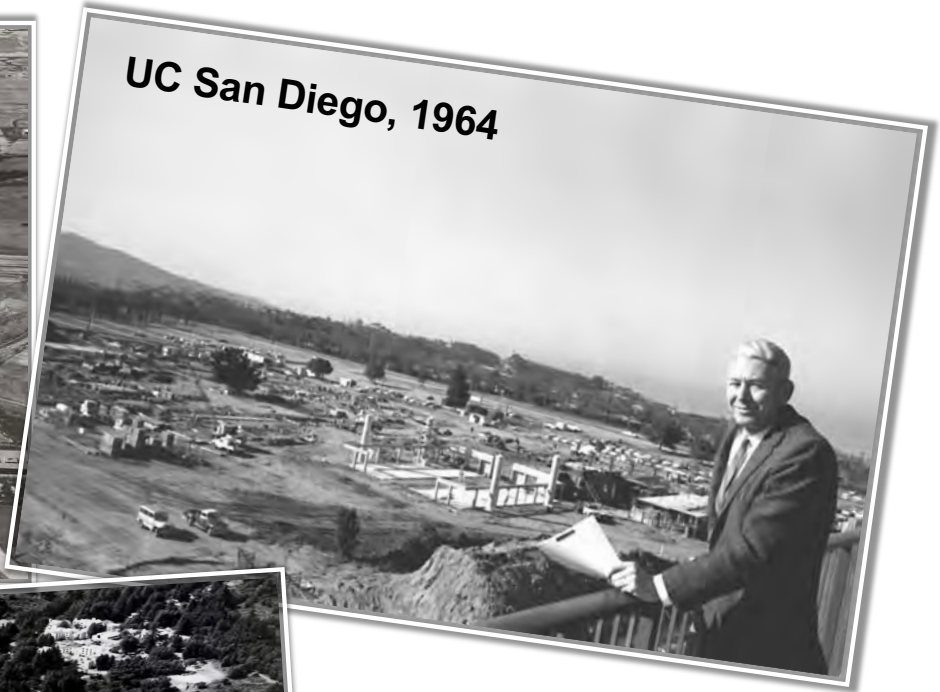

UC Santa Cruz, 1965



UC's answer to  
California's post-war  
baby boom



UC Merced opened in 2005 with 875 students

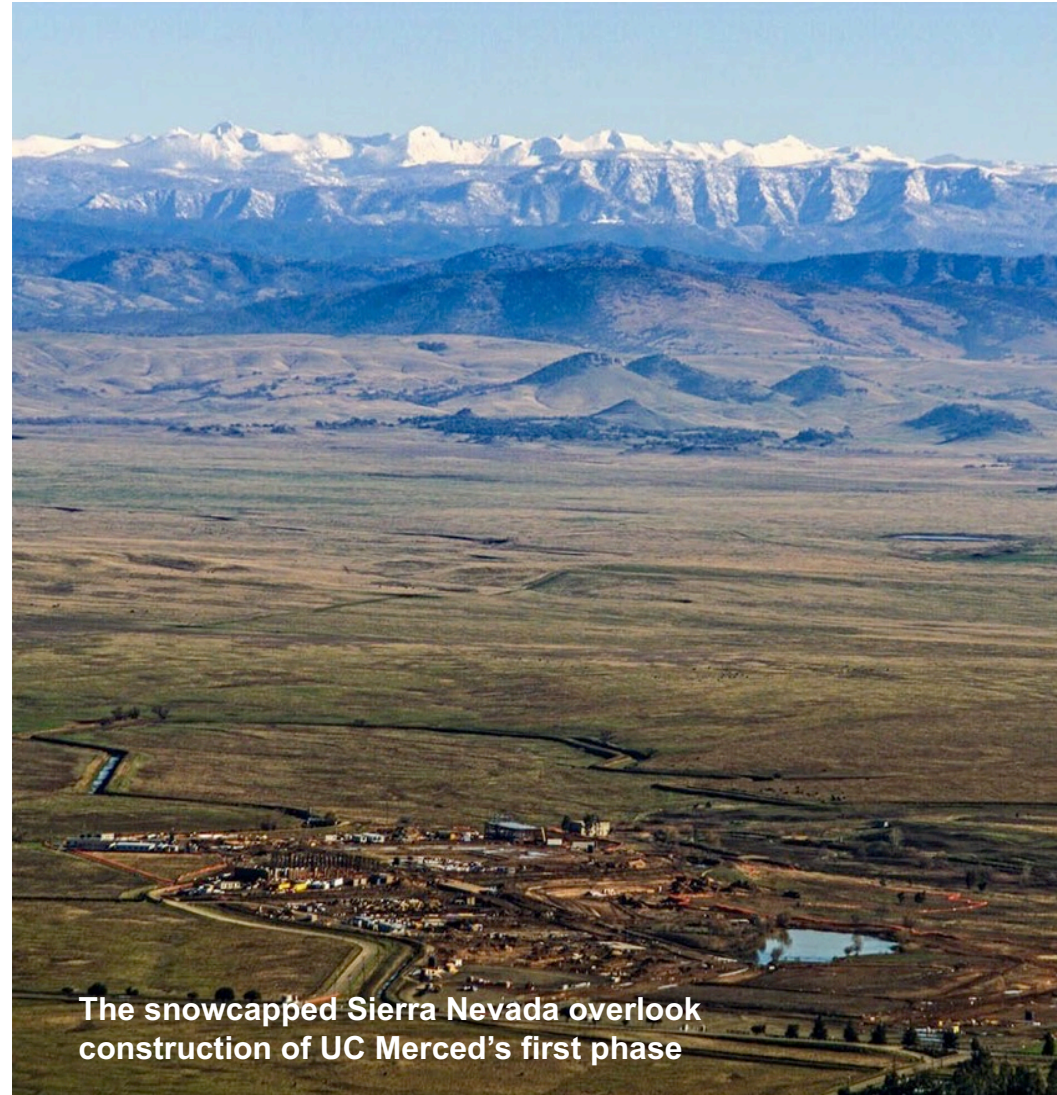

## Our students are diverse, Californian and first generation

The campus has grown to 7,900 students

72% are among the first in their families to attend a four-year university



55% majoring in science, technology engineering and math

99% of undergraduates are Californian



- **7,375 Undergraduates (Fall 2017)**
  - 29% from San Joaquin Valley
  - 28% from Los Angeles County
  - 22% from the Bay Area
- **592 Graduate Students (Fall 2017)**



**The campus features modern, high performance buildings and more than 1.4 million gross square feet**

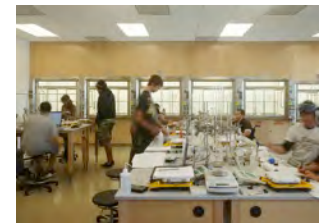
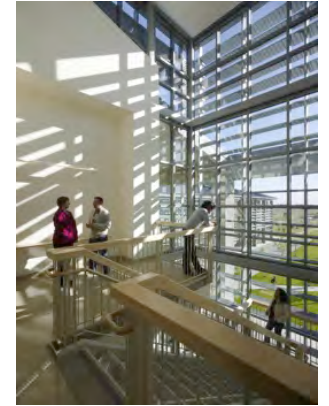

Virtually every building is certified LEED Gold or Platinum

## Recently opened Downtown Campus Center supplements UC Merced's other locations



Venture Lab  
Downtown Merced



Downtown Merced



Sierra Nevada Research Institute  
Yosemite National Park



Fresno Center



Castle Research Center  
Castle Airport, Merced



Promenade Office Park  
North Merced



# The campus expansion provides the capacity for 10,000 students



**Broke ground in October 2016**

**\$1.3 billion dollar project**

**1.2 million gross square feet**

- Research Laboratories
- Classrooms
- Student Housing
- Student Life Facilities
- Infrastructure

**Largest expansion of its kind in North America**

**\$1.9 billion of economic impact  
in the San Joaquin Valley**



The campus will double in physical size  
February 2018 Aerial View





# The project is being delivered in three phases

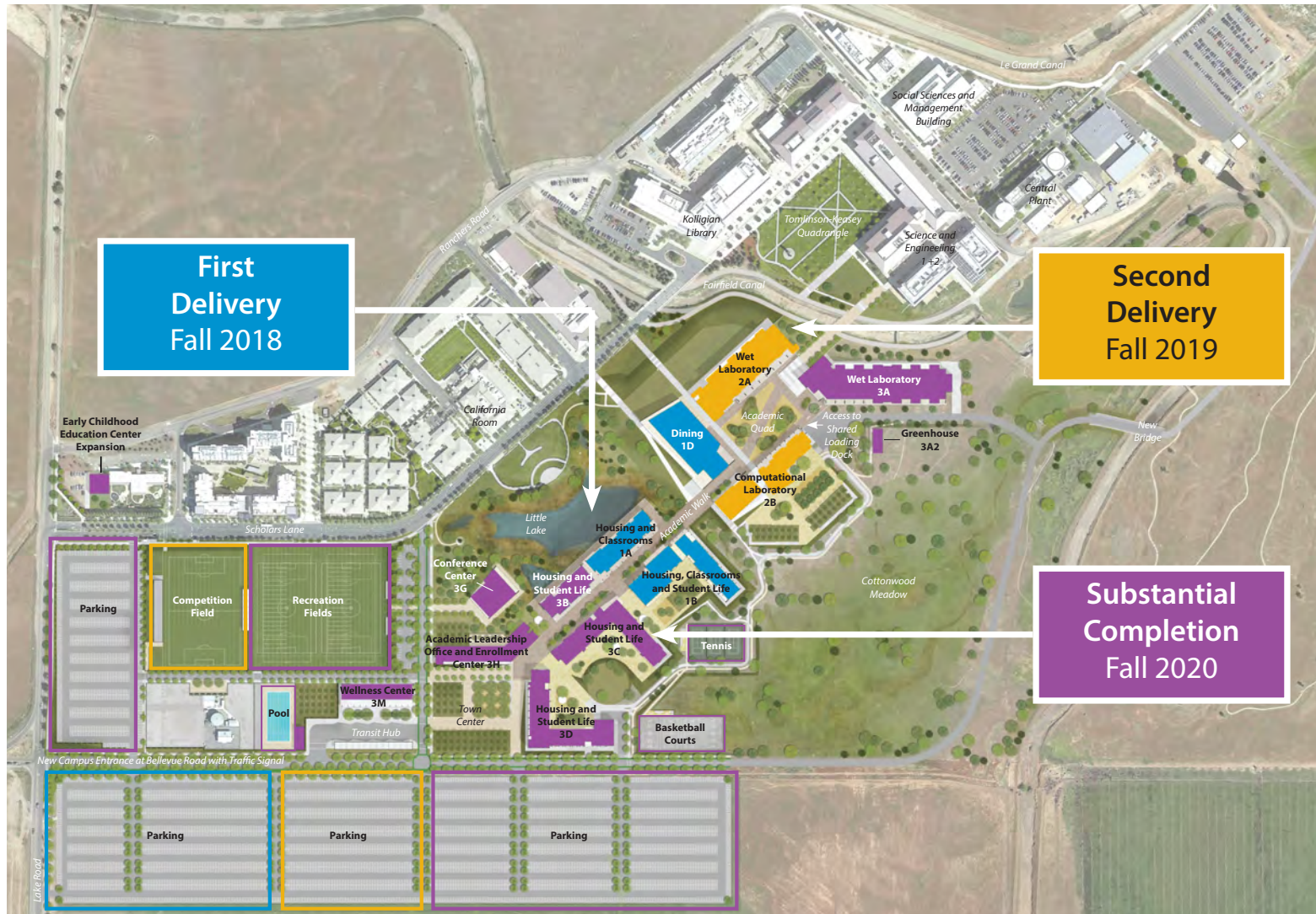



# Up to 600 design and construction workers on site each day

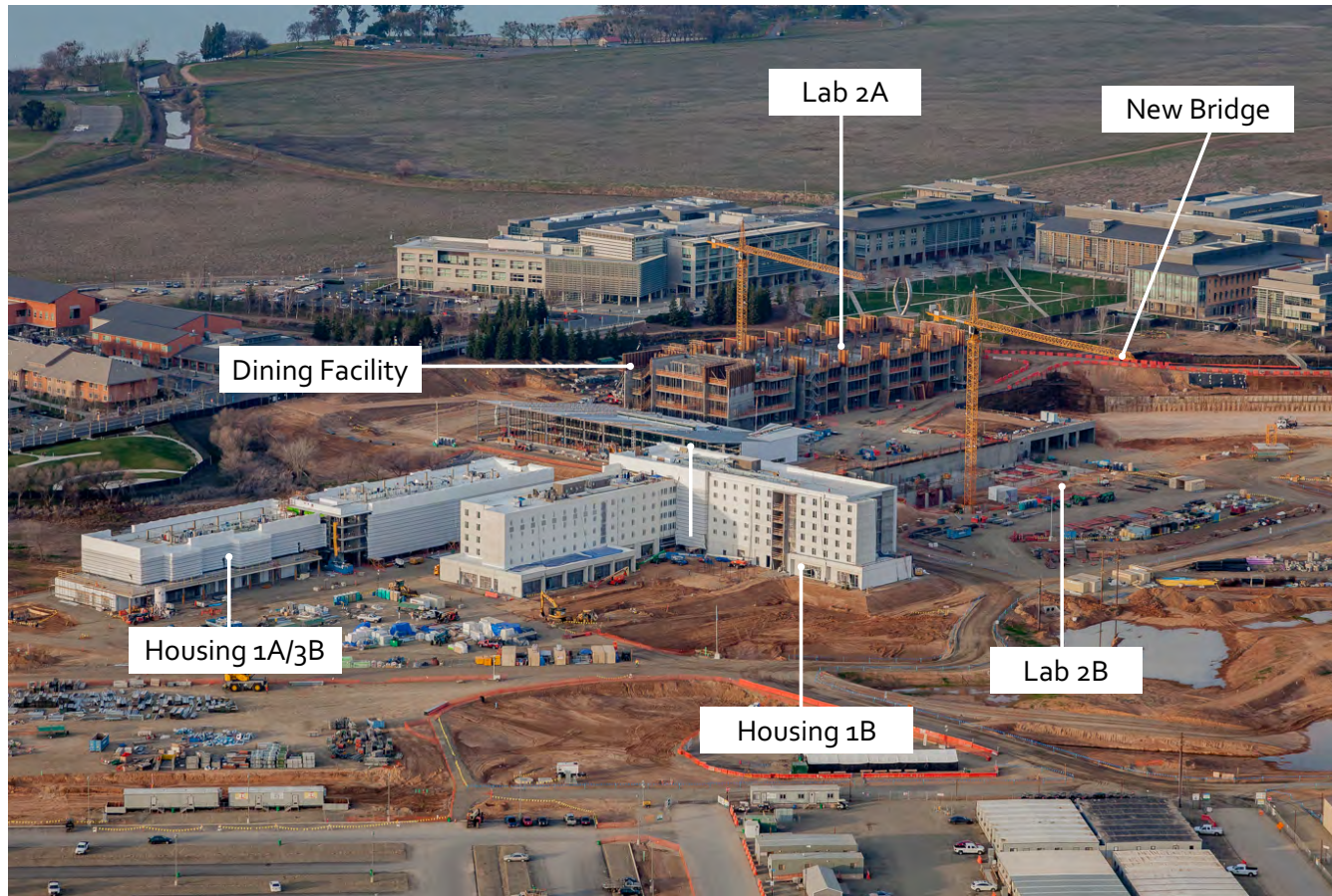

13 buildings are under simultaneous construction

February 2018



**Compact land use plan and open space**



**Mixed-use student housing with ground floor classrooms**



**State-of-the-art research facilities**



## **Key Features**

- Capacity for 10,000 students
- Energy efficient and LEED Gold minimum
- Long-term, performance-based maintenance structure



**\$440 million** has been invested to date  
30% complete



February 2018



Video Link: <http://merced2020.ucmerced.edu/buildingthefuture>





Website

[merced2020.ucmerced.edu](http://merced2020.ucmerced.edu)

Twitter/Instagram

@merced2020